

# FOR LEASE

# INTERNATIONAL TRADEPORT

BUILDING VII | 13910 ALVAREZ RD | SUITE 114 | JACKSONVILLE, FL 32218



## PROPERTY HIGHLIGHTS

**TOTAL AVAILABLE:** ± 45,000 SF

**OFFICE SPACE:** ± 3,731 SF

**PRODUCTION AREA:** ± 4,668 SF

**LOADING:** Rear

**DOCKS:** 12

**DRIVE- INS:** 1

**CLEAR HEIGHT:** 24'

**COLUMN SPACING:** 45' x 50'

**FIRE PROTECTION:** ESFR

**ELECTRICAL:** 225 Amp; 480/277 V

**ZONING:** PUD

**CONSTRUCTION:** Tilt-Wall

FOR MORE INFO:  
[WWW.GIDTRADEPORT.COM](http://WWW.GIDTRADEPORT.COM)

**GID**  
INDUSTRIAL

 **CUSHMAN & WAKEFIELD**

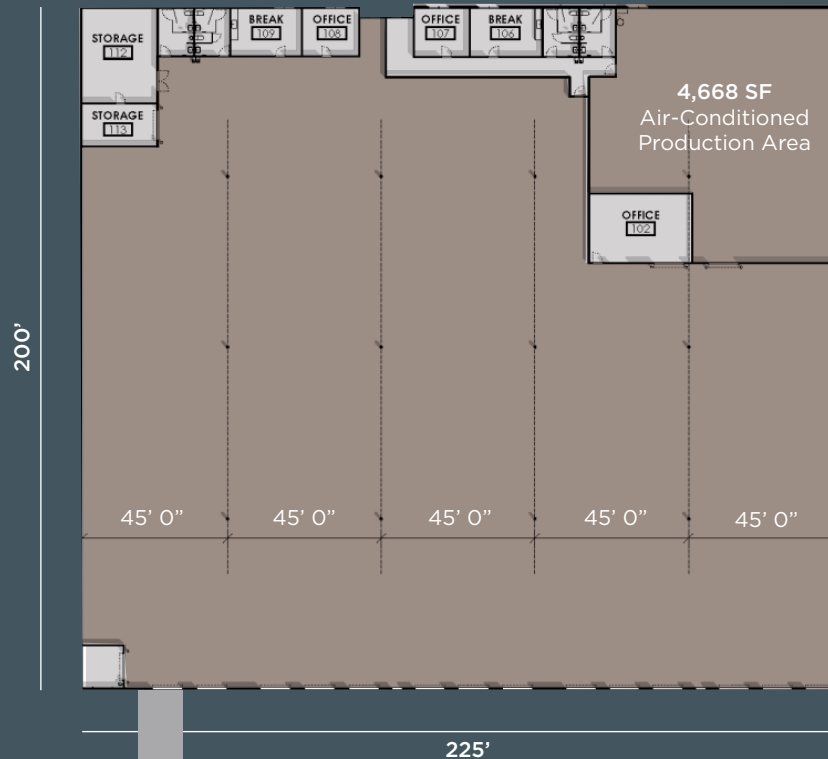

## LOCATION



## SITE PLAN

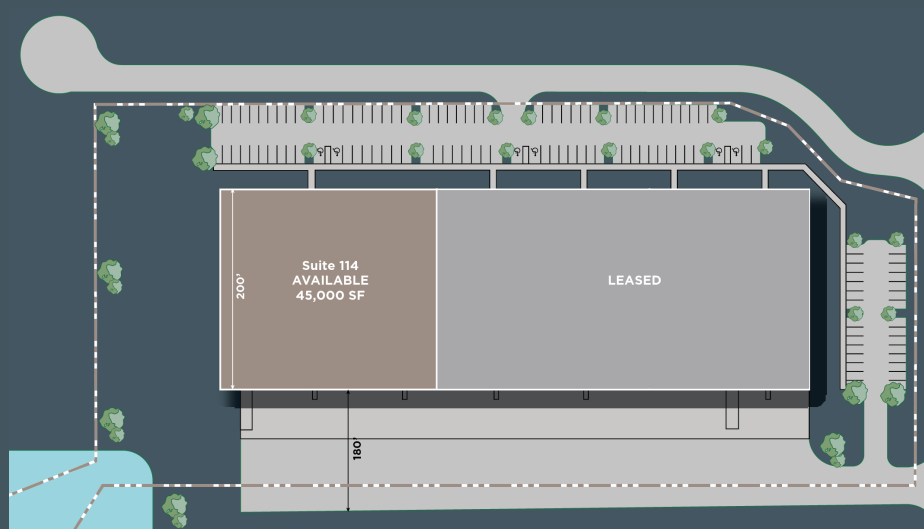

FOR MORE INFORMATION, PLEASE CONTACT:

**TYLER NEWMAN**

Executive Managing Director  
904 380 8336  
tyler.newman@cushwake.com

**JACOB HORSLEY**

Executive Managing Director  
904 380 8335  
jacob.horsley@cushwake.com

**G | I | D**  
INDUSTRIAL

**CUSHMAN & WAKEFIELD**

©2023 Cushman & Wakefield. All rights reserved. The information contained in this communication is confidential, may be privileged and is intended for the exclusive use of the above named addressee(s). If you are not the intended recipient(s), you are expressly prohibited from copying, distributing, disseminating, or in any other way using any information contained within this communication. This information has been obtained from sources believed to be reliable but has not been verified. NO WARRANTY OR REPRESENTATION, EXPRESS OR IMPLIED, IS MADE AS TO THE CONDITION OF THE PROPERTY (OR PROPERTIES) REFERENCED HEREIN OR AS TO THE ACCURACY OR COMPLETENESS OF THE INFORMATION CONTAINED HEREIN, AND SAME IS SUBMITTED SUBJECT TO ERRORS, OMISSIONS, CHANGE OF PRICE, RENTAL OR OTHER CONDITIONS, WITHDRAWAL WITHOUT NOTICE, AND TO ANY SPECIAL LISTING CONDITIONS IMPOSED BY THE PROPERTY OWNER(S). ANY PROJECTIONS, OPINIONS OR ESTIMATES ARE SUBJECT TO UNCERTAINTY AND DO NOT SIGNIFY CURRENT OR FUTURE PROPERTY PERFORMANCE. This e-mail may be considered advertising under federal law.